

Exhibit Packages

Model #1 (10' x 10')



- Choice of Wall Panel Colour
- Company ID Sign
- Carpet

Model #2 (10' x 10')



- Choice of Wall Panel Colour
- 3 Shelves
- Company ID Sign
- 1 Lockable Storage Counter, 41" High
- Carpet

Model #3 (10' x 10')



- Choice of Wall Panel Colour
- 3 Shelves
- Company ID Sign
- 1 Lockable Storage Counter, 41" High
- Carpet

Model #4 (10' x 10')

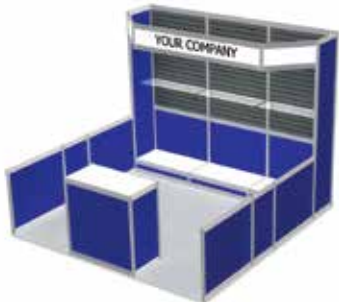

- Choice of Wall Panel Colour
- 3 Slatwall Upper Panels
- 3 Clear Acrylic Shelves
- Company ID Sign
- 1 Lockable Storage Counter, 41" High
- Carpet

Model #5 (10' x 20')



- Choice of Wall Panel Colour
- 6 Shelves
- 2 Company ID Signs
- 2 Lockable Storage Counters, 41" High
- Carpet

Model #6 (10' x 20')



- Choice of Wall Panel Colour
- 6 Slatwall Upper Panels
- 6 Clear Acrylic Shelves
- 2 Company ID Signs
- 2 Lockable Storage Counters, 41" High
- Carpet

Model #7 (10' x 20')



- Choice of Wall Panel Colour
- 1 Company ID Sign
- 2 Built-in Counters with Storage
- 2 Lockable Storage Counters, 41" High
- Carpet

Model #8 (10' x 20')



- Choice of Wall Panel Colour
- 2 Company ID Signs
- 4 Slatwall Panels
- Lockable Storage
- 2 Glass Tower Displays
- Carpet

Panel Colours

COLOURS AVAILABLE: See order forms for details



WHITE HARDWALL

GREY FABRIC

BLUE FABRIC

Slatwall Colours Models #4, 6, 8

COLOURS AVAILABLE: See order forms for details



WHITE

GREY

BLACK

All exhibit packages include rental, delivery, installation, and dismantling. Electrical & lighting requirements not included.

09-17

Exhibit Accessories Form

SHOW	O AFC CONFERENCE AND TRADE SHOW	DEADLINE DATE	April 10, 2019
LOCATION	International Centre	SHOW DATES	May 3 - 4, 2019

COMPANY				BOOTH #	
ADDRESS					
CITY		PROV / STATE		POSTAL / ZIP	
CONTACT		TITLE		EMAIL	
TEL		EXT		FAX	



Alligator Lock



Waterfall Bracket

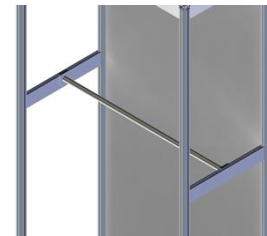

Garment Rail

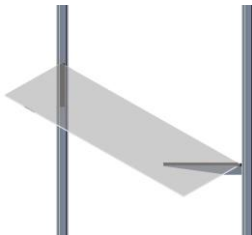

Glass Shelf

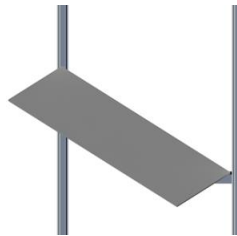

Melamine Shelf

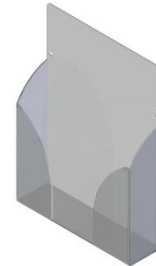

Acrylic Literature Pocket

ACCESSORIES

ITEM #	QTY	DESCRIPTION	PRE-SHOW	AFTER DEADLINE	TOTAL
604		Alligator Lock	\$ 18.00	\$ 27.00	\$
607		Waterfall Bracket	\$ 41.00	\$ 62.00	\$
609		Garment Rail	\$ 48.00	\$ 72.00	\$
605		Glass Shelf	\$ 55.00	\$ 83.00	\$
606		Melamine Shelf	\$ 43.00	\$ 65.00	\$
608		Acrylic Literature Pocket	\$ 34.00	\$ 51.00	\$

PAYMENT

Pre-show prices are only applicable if payment is received prior to deadline date

Note: You must complete a credit card authorization form if you are paying by cheque

VISA MC AMEX CHQ

SUB TOTAL	
13% HST	
TOTAL	

CARD NUMBER

EXPIRY DATE

I have read and understand the Terms & Conditions of my agreement with Stronco

HST# R129612164

CARD HOLDER

SIGNATURE

DATE

TERMS & CONDITIONS

- All orders must be paid in full 7 days prior to show set-up.
- All prices are for the duration of the show, unless otherwise stated.
- No cheques will be accepted on-site.
- All orders received after the deadline date will be processed at the stated "After Deadline Date" price and are subject to availability. **Pre-show prices are only applicable if payment is received prior to deadline date.**
- If no Deadline Date is specified, orders must be received 14 days before show set-up to receive Pre-Show Pricing.

- Refunds will not be given on orders cancelled on-site.
- A 70% refund will be allowed on all written cancellations received 7 days prior to set-up, excluding display rentals and signage.
- All claims/discrepancies must be settled prior to show closing.
- If no colour is indicated, Stronco will make the selection on your behalf.
- Stronco will not be responsible for any materials or products left in exhibits, counters, storage units or showcases.

J48414
07-10-17+17-50-T2